

NT1 & AI 1 Quickstart Guide

NT1

1 Put Shock Mount on Mic Stand

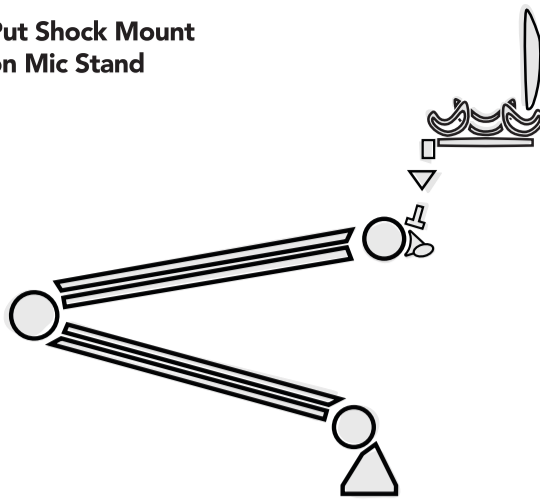

2 Mount NT1 in SMR Shock Mount

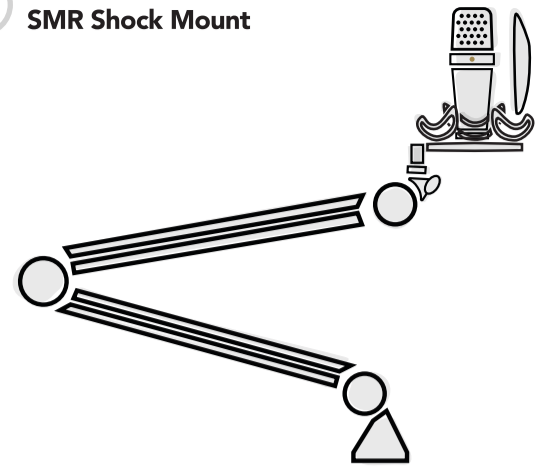

3 Connect XLR Cable to NT1

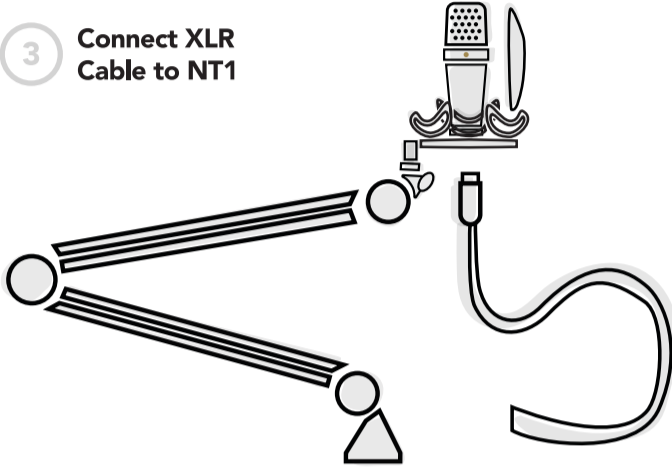

AI-1 INTERFACE

4 Connect AI-1 Interface to computer

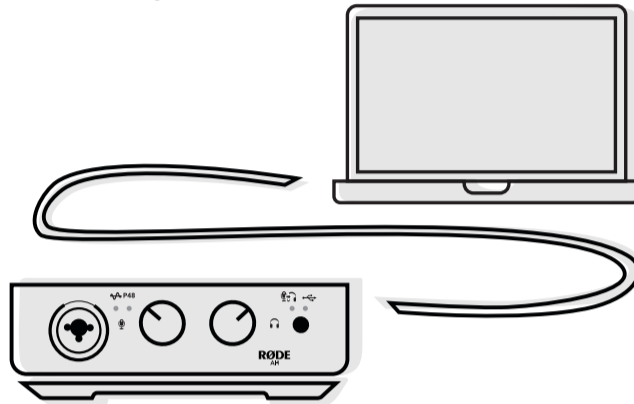

5 Connect NT1 to AI-1 Interface

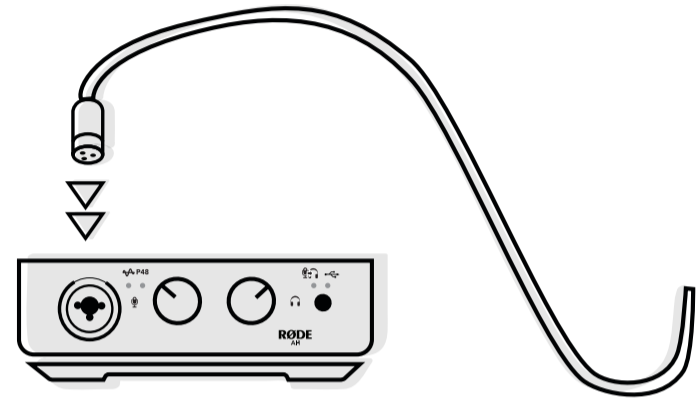

6 Enable Phantom Power (P48)
This is required for condenser microphones

A Enable P48 for NT1
Press left knob to enable,
P48 light illuminates red

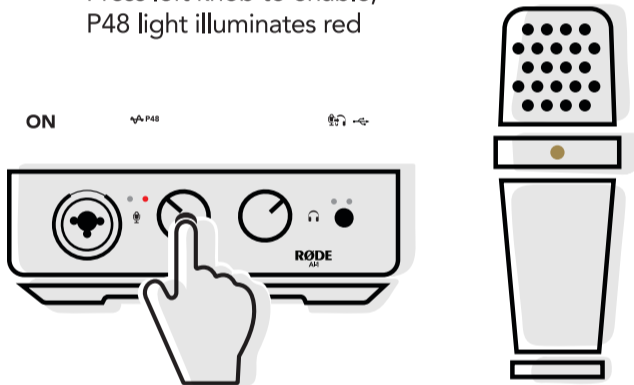

B Disable P48 for dynamic microphones
Press left knob to disable,
P48 light darkens

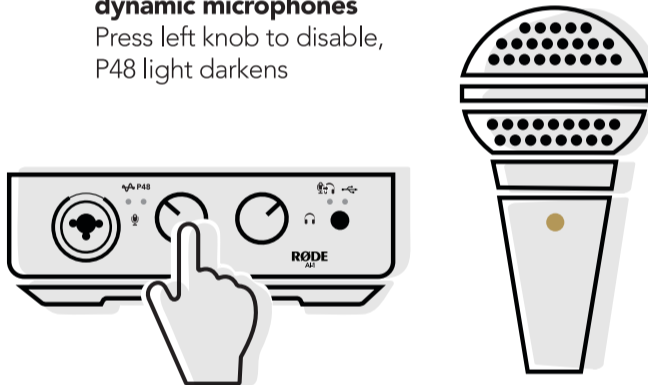

7 Set Input Level

A Green is good

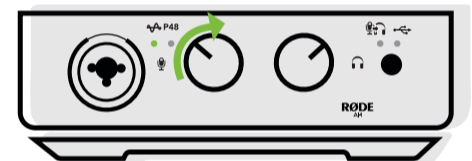

B Turn down when Red

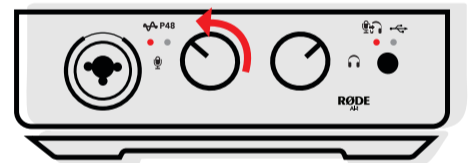

8 Connect headphones, adjust volume
*headphones not included

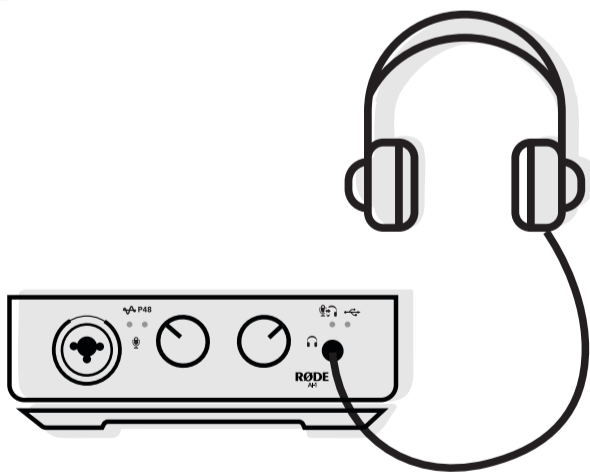

9 Enable Direct Monitor by pressing right knob

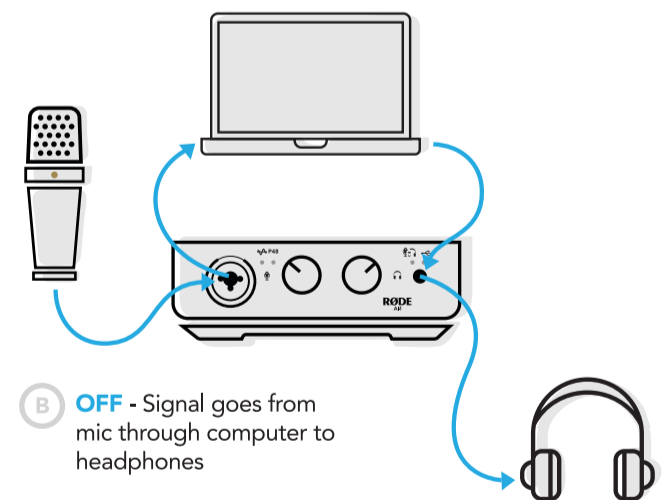
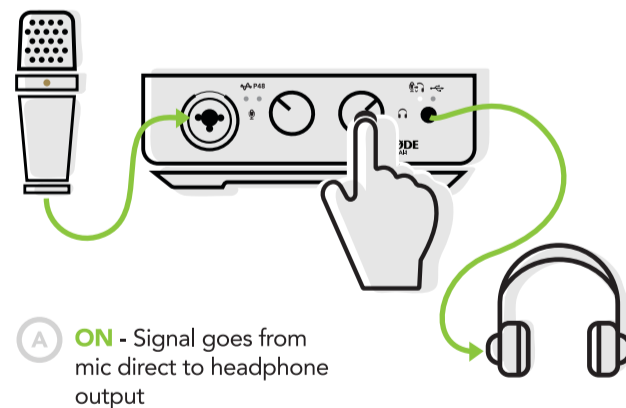

10 If desired, connect powered speakers
*disconnect headphones to activate speaker output

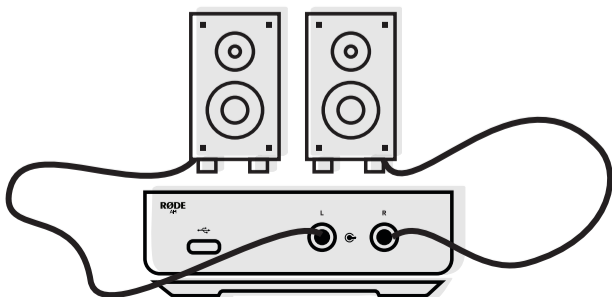

You're now
ready to create!

Love your new product?
Share with us [#rodeai1](#)

@rodemic
 @rodemics
 rodemic



Scan the
QR code
to find
out more

www.rodem.com